



Pennington Close, Billingham

Billingham



Guide Price £150,000



21 Pennington Close

Billingham

Presenting a wonderful opportunity for first-time buyers and families alike, this charming and well-maintained three-bedroom end-terrace property is sure to captivate all who view it. Situated in the sought-after area of High Grange in Billingham, it boasts an enviable location close to local shops, schools, and convenient bus routes.

With its own driveway and garage, this property offers ample parking space for multiple vehicles. Stepping into the welcoming entrance hall, you are led into a spacious lounge area, perfect for relaxation and entertaining. The practicality of the property is evident through its well-designed kitchen/diner, providing a comfortable space for family meals and social gatherings.

Ascending the stairs, you will find a bright and airy landing leading to the three bedrooms. Each room has been thoughtfully designed to maximise space and functionality. The bathroom offers both a bath and a separate shower, ensuring utmost convenience.

Benefiting from UPVC double glazing and gas central heating, this property guarantees warmth and energy efficiency throughout the year. To the rear, a generously-sized garden provides endless possibilities for outdoor activities, from alfresco dining to children's play.

Enquire today to seize the opportunity to make this property your perfect family home.

Council Tax band: B | Tenure: Freehold

- Three Bedroom End Terrace
- Driveway & Garage



- Three Bedroom End Terrace
- Driveway & Garage
- Large Garden To Rear
Perfect For First Time Buyers &
- Families
UPVC Double Glazing & Gas
- Central Heating
- Energy Efficiency Rating: TBC



Entrance Hall

Lounge

15' 1" x 11' 1" (4.60m x 3.39m)

Kitchen/Diner

22' 5" x 11' 6" (6.82m x 3.50m)

Landing

Bathroom

5' 7" x 10' 11" (1.69m x 3.34m)

Bedroom One

11' 7" x 13' 1" (3.54m x 4.00m)

Bedroom Two

11' 7" x 9' 6" (3.54m x 2.90m)

Bedroom Three

5' 7" x 10' 11" (1.69m x 3.34m)







Ground Floor

Approx. 52.2 sq. metres (561.3 sq. feet)

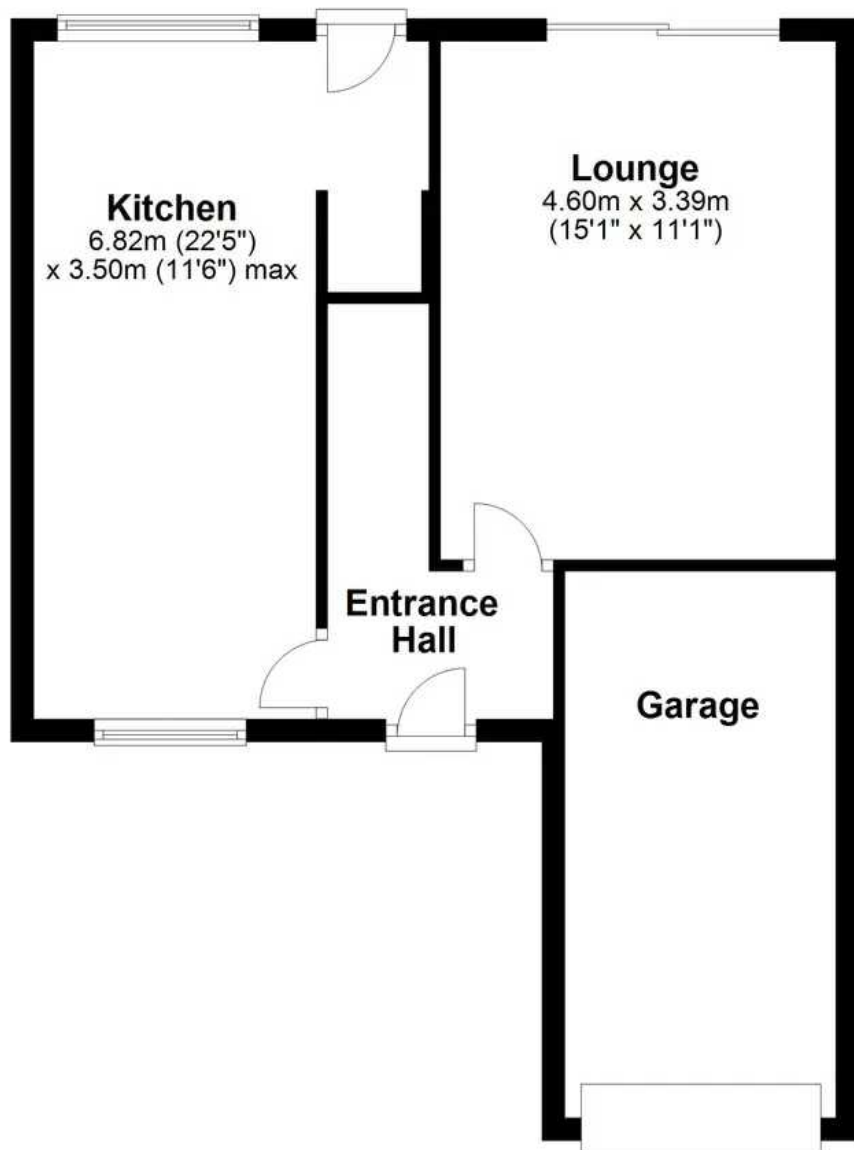

First Floor

Approx. 41.2 sq. metres (443.2 sq. feet)

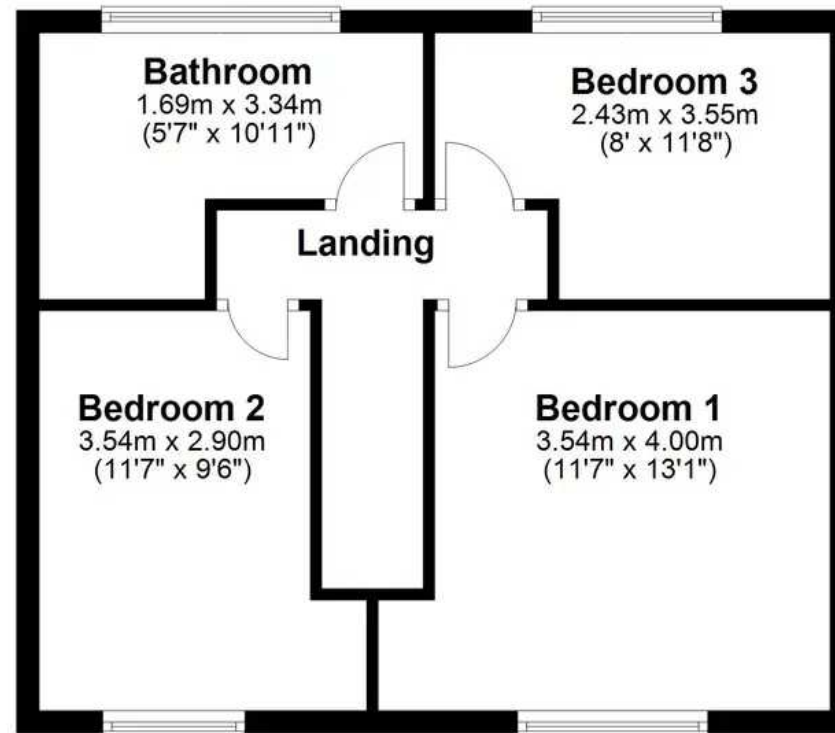

Total area: approx. 93.3 sq. metres (1004.6 sq. feet)

floor plan(s) by Northgate² for illustration purpose only all measurements are approximate.
Plan produced using PlanUp.



Northgate - Teesside

8 Town Square, Billingham - TS23 2LY

01642 813222 • billingham@northgates.net • www.northgates.co.uk/

