



Thornton Street, Darlington  
Darlington



£635 pcm



## Thornton Street

Darlington

Rent: £635 PCM | Deposit: £685 | Holding Deposit: £146.54

A beautifully presented recently upgraded two-bedroom terraced property offering spacious and versatile accommodation, ideally suited to professionals, couples, or small families.

Entering into a vestibule leading to the hallway, the property immediately offers a welcoming sense of space. The ground floor benefits from brand-new plush carpeting across two generous reception rooms, creating flexible, seamless living and dining areas. The front reception room benefits from a large bay window, allowing an abundance of natural light to flood the space, while decorative fireplaces add character and charm. Neutral decor and tasteful finishes enhance the bright and inviting atmosphere throughout.

To the rear of the property is a stunning, newly fitted contemporary kitchen. Designed with modern living in mind, it features sleek white units, stylish dark work surfaces, an integrated oven & hob. A large window creates a light, airy environment, making it an ideal space for both daily cooking and entertaining.

To the first floor are two well-proportioned bedrooms, each finished in neutral tones and benefitting from large windows that provide plenty of natural light. The contemporary bathroom features a white suite comprising a bath with overhead shower, stylish tiling, built-in storage, and a frosted window providing privacy while maintaining a bright feel.

Externally, the property enjoys an enclosed courtyard to the rear, offering a low-maintenance outdoor space.



**Vestibule**

3' 5" x 3' 2" (1.05m x 0.97m)

**Lounge**

12' 8" x 11' 11" (3.85m x 3.62m)

**Dining Room**

12' 7" x 12' 0" (3.83m x 3.66m)

**Kitchen**

12' 6" x 6' 10" (3.80m x 2.09m)

**Hallway**

12' 0" x 3' 2" (3.65m x 0.97m)

**Landing**

6' 1" x 2' 8" (1.86m x 0.81m)

**Landing**

8' 11" x 3' 1" (2.73m x 0.93m)

**Bedroom 1**

15' 8" x 12' 8" (4.77m x 3.87m)

**Bedroom 2**

12' 8" x 9' 3" (3.85m x 2.81m)

**Bathroom**

12' 2" x 6' 10" (3.70m x 2.08m)



YARD







Northgate  
estate agents



Northgate  
estate agents



Northgate  
estate agents



Northgate  
estate agents



Northgate  
estate agents



Ground Floor

Approximate total area<sup>(1)</sup>

904 ft<sup>2</sup>

83.9 m<sup>2</sup>

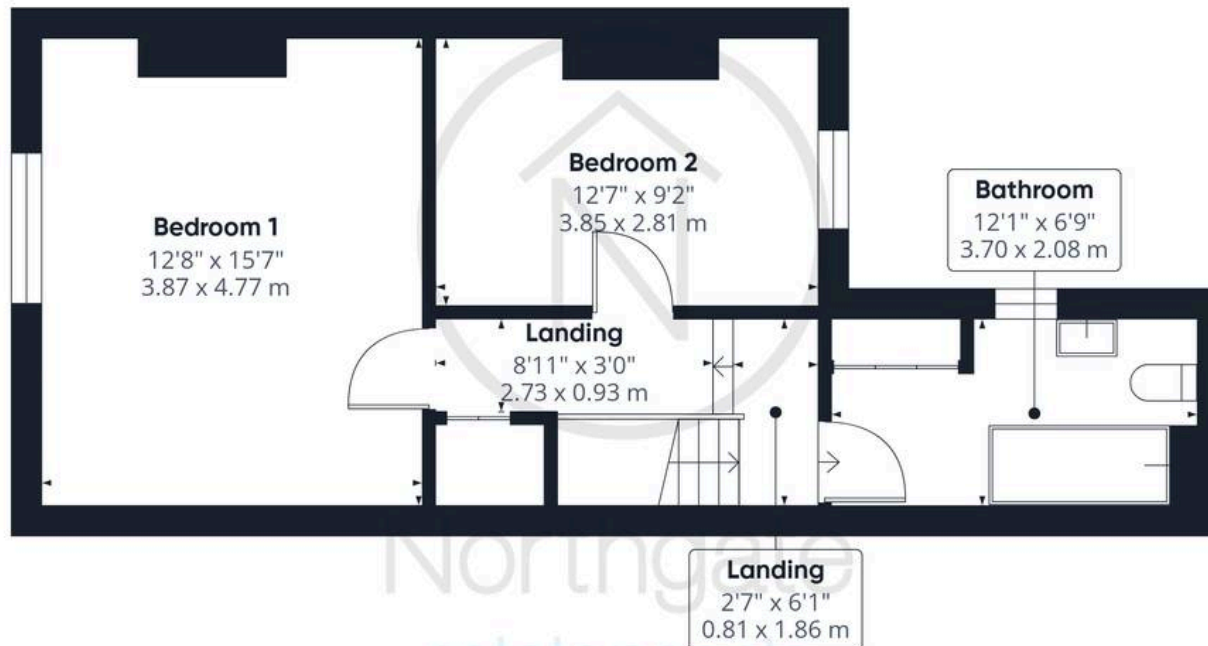

Floor 1



(1) Excluding balconies and terraces

Calculations reference the RICS IPMS 3C standard. Measurements are approximate and not to scale. This floor plan is intended for illustration only.

GIRAFFE360



## Northgate - County Durham

Suite 3, Avenue House, Greenwell Road, Newton Aycliffe - DL5 4DH

01325 728333 • [info@northgates.net](mailto:info@northgates.net) • [www.northgates.co.uk/](http://www.northgates.co.uk/)



These particulars do not constitute, nor constitute part of, an offer or contract. No warranties are provided. Verify details through inspection. Northgate estate agents, nor any person in their employment has any authority to make or give any representation or warranty whatever in the relation to this property. All measurements are approximate.