



28 Westfields, School Aycliffe
Newton Aycliffe



Offers in Region of £270,000



28 Westfields

School Aycliffe, Newton Aycliffe

Nestled within a small and exclusive cul-de-sac in the highly regarded Westfields area of School Aycliffe, this fantastic three-bedroom detached bungalow offers spacious and versatile accommodation throughout.

The property welcomes you with a generous entrance hallway leading to a modern fitted kitchen, a spacious lounge, a separate dining room, two bright and airy sunrooms, and a contemporary family bathroom.

Externally, the front of the property is laid to lawn, while the rear boasts an excellent-sized garden, also laid to lawn, providing plenty of outdoor space to enjoy. There is a detached double garage and a block paved driveway offering ample off-street parking. The property also benefits from a new roof installed in November 2025, offering added peace of mind for prospective purchasers.

School Aycliffe is ideally positioned close to local shops and recreational facilities, with further amenities available in Newton Aycliffe. Darlington town centre, offering a more comprehensive range of shopping and leisure facilities, is just a short drive away.

Council Tax band: C

Tenure: Freehold

- Three Bedroom Detached Bungalow
- Two Sunrooms Providing Additional Living Space
- Modern Fitted Kitchen & Contemporary Family Bathroom
- Detached Double Garage & Block Paved Driveway with Ample Parking
- Exclusive Cul-De-Sac Location in Westfields, School Aycliffe
- Energy Performance Certificate: TBC



Hallway

13'2" × 4'6" (4.01 × 1.39 m) 5'4" × 5'3" (1.63 × 1.61 m)

Lounge

15'6" × 12'4" (4.73 × 3.78 m)

Sunroom

10'5" × 10'8" (3.19 × 3.25 m)

Dining Room

10'11" × 10'4" (3.34 × 3.16 m)

Kitchen

12'1" × 9'9" (3.69 × 2.98 m)

Sunroom

10'4" × 10'7" (3.17 × 3.24 m)

Bedroom 1

10'10" × 11'3" (3.33 × 3.43 m)

Bedroom 2

7'5" × 11'3" (2.27 × 3.43 m)

Bedroom 3

9'9" × 6'11" (2.98 × 2.12 m)

Bathroom

7'3" × 5'3" (2.23 × 1.61 m)

Garage

16'0" × 15'11" (4.90 × 4.87 m)





FRONT GARDEN

REAR GARDEN

GARAGE

Single Garage

DRIVEWAY

2 Parking Spaces









Northgate
estate agents

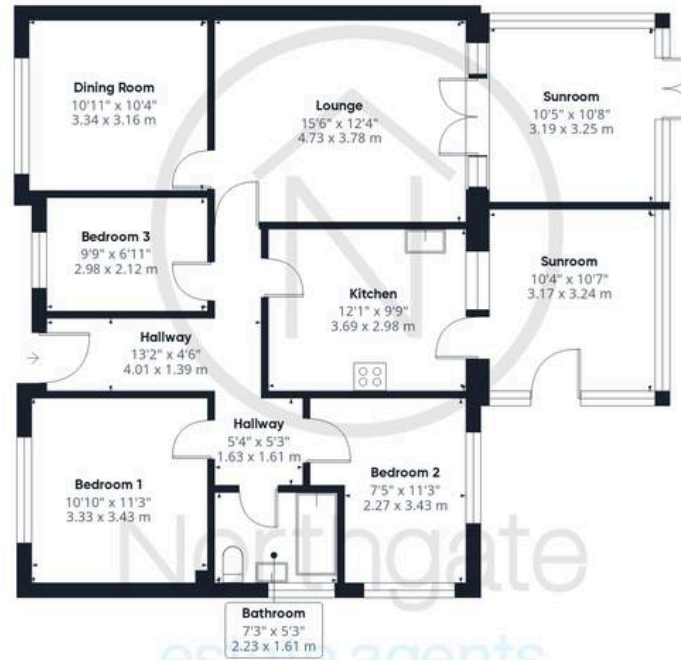

Ground Floor Building 1

Approximate total area⁽¹⁾

1350 ft²

125.3 m²



Ground Floor Building 2

(1) Excluding balconies and terraces

Calculations reference the RICS IPMS 3C standard. Measurements are approximate and not to scale. This floor plan is intended for illustration only.

GIRAFFE360



Northgate - County Durham

Suite 3, Avenue House, Greenwell Road, Newton Aycliffe - DL5 4DH

01325 728333 • info@northgates.net • www.northgates.co.uk/



These particulars do not constitute, nor constitute part of, an offer or contract. No warranties are provided. Verify details through inspection. Northgate estate agents, nor any person in their employment has any authority to make or give any representation or warranty whatever in the relation to this property. All measurements are approximate.