



Hedley Close, Newton Aycliffe
Newton Aycliffe



Offers In Excess of £70,000



Hedley Close

Newton Aycliffe

Introducing this well-presented three-bedroom end-of-terrace home, offered with no onward chain, and providing a comfortable and practical layout in a convenient and popular residential location. Ideal for a wide range of buyers, the property successfully combines functionality with modern living.

The ground floor comprises a fitted kitchen/diner, providing an excellent space for everyday meals and family living, alongside the added benefit of a downstairs WC. The lounge is bright and inviting, filled with natural light and offering generous space for both relaxing and entertaining.

To the first floor are three well-proportioned bedrooms, complemented by a modern family bathroom that completes the accommodation.

In summary, this attractive three-bedroom home offers a well-balanced and flexible layout, perfectly suited to comfortable day-to-day living. With its spacious lounge, practical kitchen/diner, desirable location, and the benefit of no onward chain, it presents a fantastic opportunity for buyers seeking a smooth and straightforward purchase.

Council Tax band: A

Tenure: Freehold



- Semi detached
- Ground floor WC
- 3 bedrooms
- Enclosed garden
- No onward chain
- Energy Performance Certificate : C

Hallway

16'2" x 5'8" (4.93m x 1.74m)

WC

4'10" x 2'6" (1.48m x 0.78m)

Kitchen/Diner

13'3" x 11'3" (4.05m x 3.43m)

Lounge

10'6" x 17'4" (3.22m x 5.31m)

Landing

14'7" x 5'9" (4.46m x 1.76m)

Bedroom 1

10'0" x 14'8" (3.05m x 4.47m)

Bedroom 2

10'6" x 10'5" (3.21m x 3.18m)

Bedroom 3

6'4" x 11'4" (1.94m x 3.46m)

Bathroom

5'7" x 6'9" (1.70m x 2.07m)





GARDEN









Northgate
estate agents

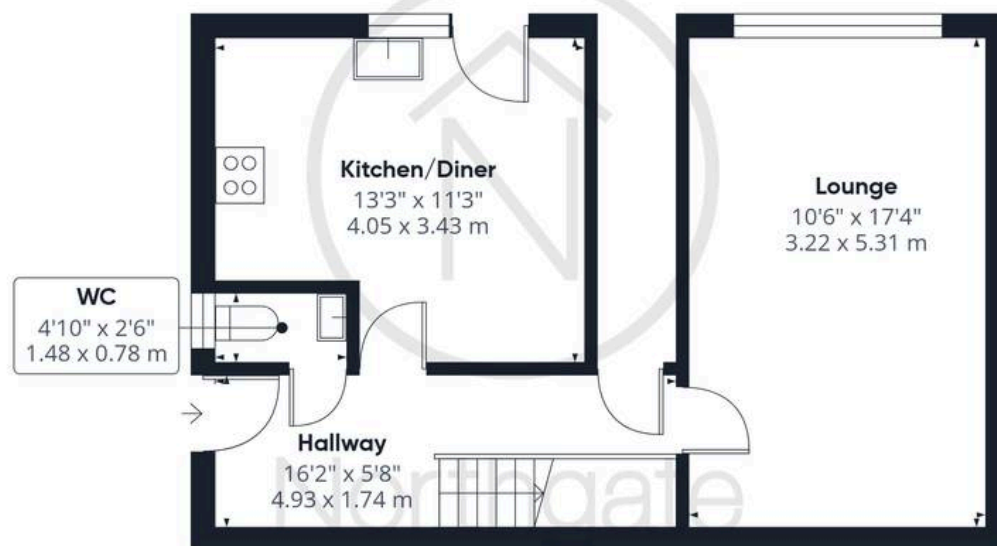

Ground Floor

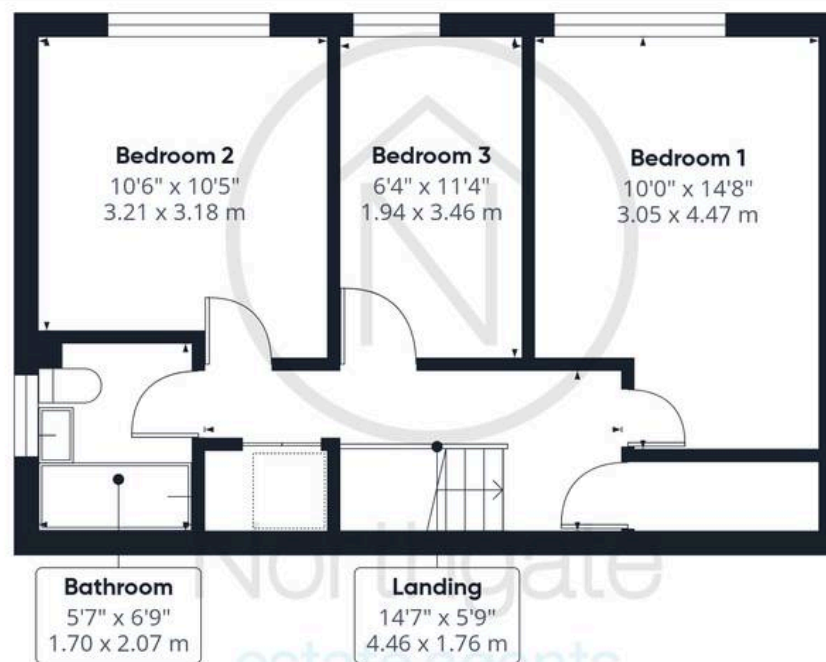

Floor 1



Approximate total area⁽¹⁾

865 ft²

80.2 m²

(1) Excluding balconies and terraces

Calculations reference the RICS IPMS 3C standard. Measurements are approximate and not to scale. This floor plan is intended for illustration only.

GIRAFFE360



Northgate - County Durham

Suite 3, Avenue House, Greenwell Road, Newton Aycliffe - DL5 4DH

01325 728333 • info@northgates.net • www.northgates.co.uk/



These particulars do not constitute, nor constitute part of, an offer or contract. No warranties are provided. Verify details through inspection. Northgate estate agents, nor any person in their employment has any authority to make or give any representation or warranty whatever in the relation to this property. All measurements are approximate.