



Chestnut Way, Newton Aycliffe
Newton Aycliffe



In Excess of £257,500



34 Chestnut Way

Newton Aycliffe, Newton Aycliffe

This beautifully laid-out home offers four bedrooms, a separate dining room and an integral garage, making it an ideal choice for family living.

The ground floor features a welcoming hallway that leads to the dining room, a bright and airy lounge with French doors opening onto the garden, and a modern kitchen with a breakfast area. The integral garage can also be accessed from the hallway, providing practical storage as well as secure parking.

Upstairs, the property continues to impress with four generously sized bedrooms, three of which are doubles. The main bedroom benefits from its own en-suite, while a family bathroom and a convenient downstairs WC help ensure busy mornings run seamlessly.

Externally, the property benefits from ample driveway parking leading to the garage. To the rear, there is a patio area with raised railway sleeper borders, a turfed lawn and planted shrubs, creating an attractive outdoor space.

Council Tax band: D

- Detached four-bedroom family home
- Modern lounge with French doors
- Separate Dining Room/Study
- Master bedroom with en-suite
- Integral garage and driveway
- Energy Performance Certificate: B



Hallway

3'0" × 16'3" (0.92 × 4.96 m)

Study

8'7" × 9'0" (2.63 × 2.75 m)

Lounge

11'7" × 15'3" (3.53 × 4.67 m)

Kitchen/Diner

9'6" × 13'10" (2.90 × 4.23 m)

WC

4'9" × 3'5" (1.45 × 1.04 m)

Garage

8'8" × 17'0" (2.65 × 5.20 m)

Landing

7'3" × 6'7" (2.23 × 2.02 m)

Bedroom 1

12'0" × 13'10" (3.67 × 4.22 m)

En-suite

7'9" × 4'11" (2.38 × 1.52 m)

Bedroom 2

11'10" × 9'0" (3.61 × 2.76 m)

Bedroom 3

8'11" × 13'10" (2.73 × 4.23 m)

Bedroom 4

8'11" × 7'4" (2.72 × 2.24 m)

Bathroom

7'9" × 6'7" (2.38 × 2.03 m)





FRONT GARDEN

REAR GARDEN

GARAGE

Single Garage

DRIVEWAY

2 Parking Spaces









Northgate
estate agents

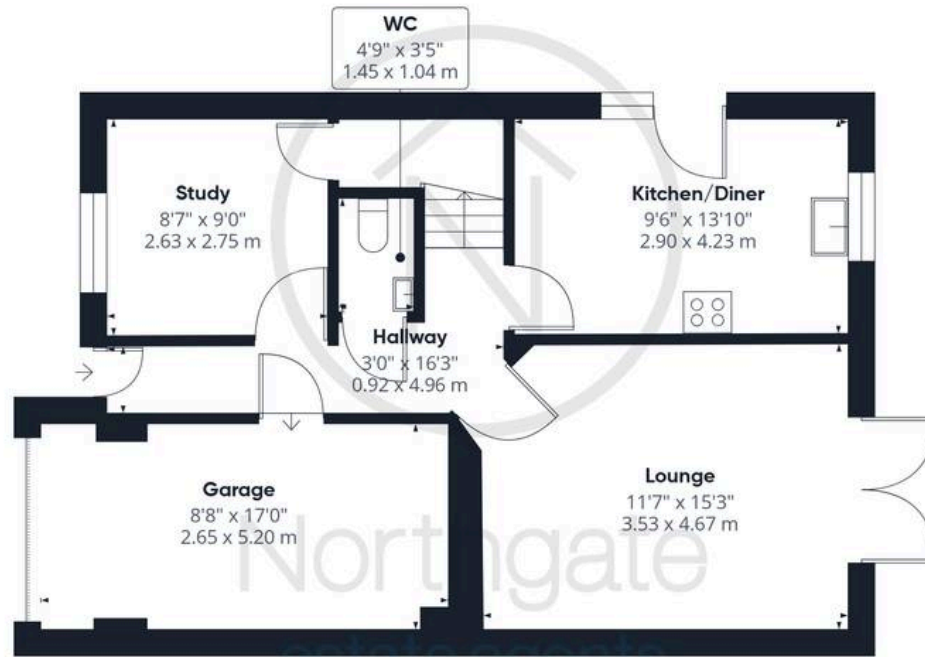

Ground Floor

Approximate total area⁽¹⁾

1221 ft²

113.6 m²

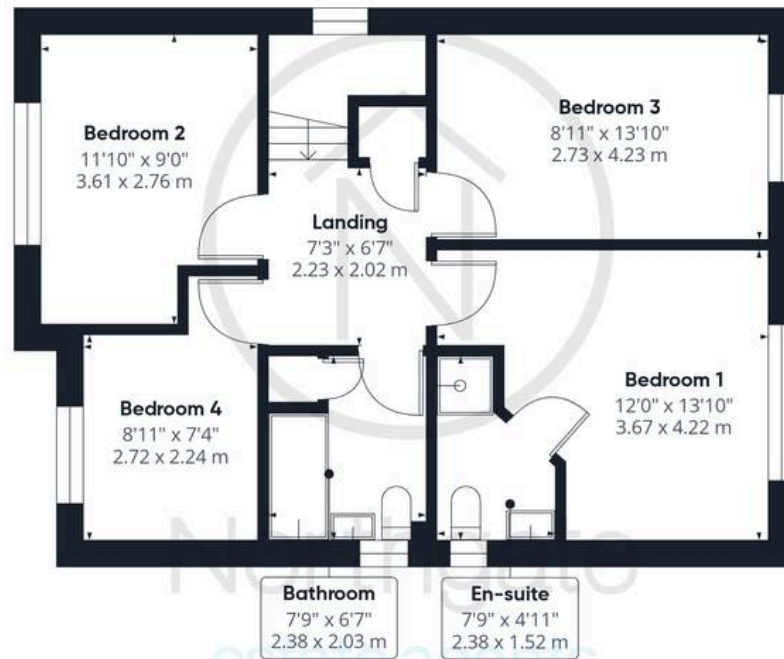

Floor 1



(1) Excluding balconies and terraces

Calculations reference the RICS IPMS 3C standard. Measurements are approximate and not to scale. This floor plan is intended for illustration only.

GIRAFFE360



Northgate - County Durham

Suite 3, Avenue House, Greenwell Road, Newton Aycliffe - DL5 4DH

01325 728333 • info@northgates.net • www.northgates.co.uk/



These particulars do not constitute, nor constitute part of, an offer or contract. No warranties are provided. Verify details through inspection. Northgate estate agents, nor any person in their employment has any authority to make or give any representation or warranty whatever in the relation to this property. All measurements are approximate.