



57 Langdale Road, Darlington
Darlington



Offers in Region of £95,000



57 Langdale Road

Darlington, Darlington

Two-Bedroom End Terrace – Eastbourne, Darlington

Situated in the popular Eastbourne area of Darlington, just a short walk from the railway station, this two-bedroom end terrace offers a practical layout and excellent location for commuting.

The ground floor comprises a spacious lounge flowing into a separate dining room, with a kitchen positioned at the rear. Upstairs, you'll find two well-proportioned bedrooms and a generous bathroom.

Externally: The property benefits from a small front garden and a rear yard.

With local shops and excellent transport links close at hand, it's well placed for everyday convenience.

Council Tax band: A

Tenure: Freehold

- Two Bedroom End of Terrace
- Lounge / Dining Room / Kitchen
- Two Bedrooms / Bathroom
- Eastbourne Location
- Close to Darlington Railway Station
- Energy Performance Certificate: E



Vestibule

2'11" × 3'3" (0.91 × 0.99 m)

Lounge

15'1" × 12'0" (4.62 × 3.68 m)

Hallway

3'5" × 2'9" (1.05 × 0.84 m)

Dining Room

15'10" × 8'2" (4.84 × 2.51 m)

Kitchen

5'8" × 14'6" (1.74 × 4.44 m)

Landing

2'11" × 2'10" (0.90 × 0.87 m)

Bedroom 1

12'8" × 12'1" (3.88 × 3.69 m)

Bedroom 2

12'8" × 8'4" (3.86 × 2.54 m)

Bathroom

5'8" × 14'6" (1.75 × 4.43 m)





FRONT GARDEN

REAR GARDEN





Ground Floor

Approximate total area⁽¹⁾

874 ft²

81.1 m²

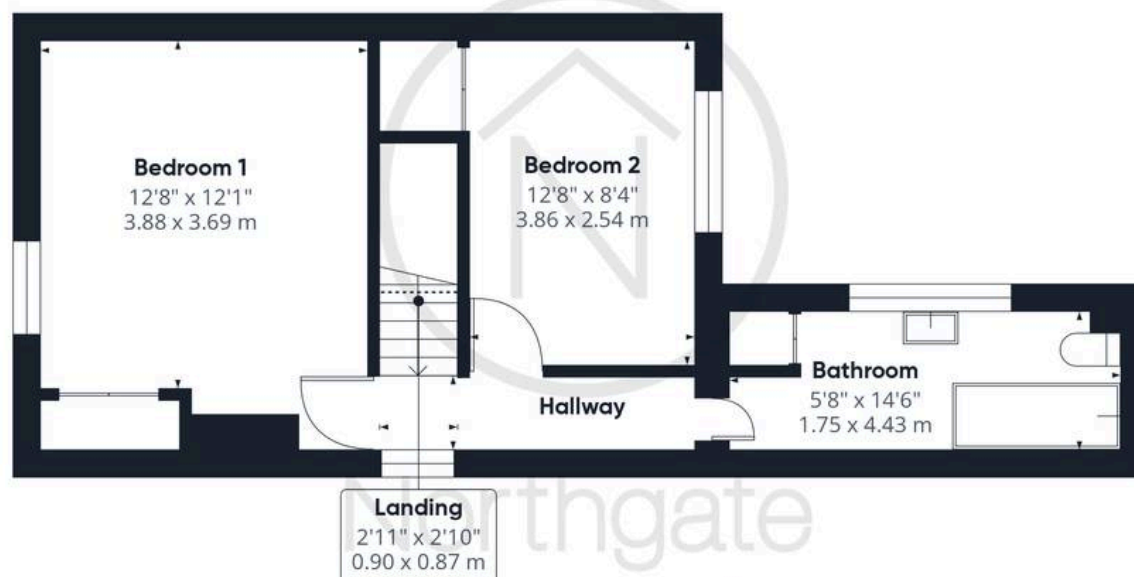

Floor 1

(1) Excluding balconies and terraces

Reduced headroom

..... Below 5 ft/1.5 m

Calculations reference the RICS IPMS 3C standard. Measurements are approximate and not to scale. This floor plan is intended for illustration only.

GIRAFFE360



Northgate - County Durham

Northgate Estate Agents, Suite 3 - DL5 4DH

01325 728333 • info@northgates.net • www.northgates.co.uk/



These particulars do not constitute, nor constitute part of, an offer or contract. No warranties are provided. Verify details through inspection. Northgate estate agents, nor any person in their employment has any authority to make or give any representation or warranty whatever in the relation to this property. All measurements are approximate.