



St. Andrews Close, Aycliffe

Newton Aycliffe



In Excess of £155,000



3 St. Andrews Close

Aycliffe, Newton Aycliffe

Nestled in the charming Aycliffe Village, this delightful three-bedroom mid-terraced house offers a perfect blend of comfort and convenience. Boasting a spacious lounge and a separate dining room, this property provides the ideal setting for both relaxation and entertainment. The three well-proportioned bedrooms offer ample accommodation space for a growing family, while the family bathroom provides a sanctuary for relaxation after a long day. Tastefully designed and well-maintained, this property features a low maintenance rear garden, perfect for those seeking a private outdoor space to enjoy sunny afternoons or host intimate gatherings.

Externally : The property offers a tranquil escape with its low maintenance rear garden providing a peaceful retreat from the hustle and bustle of daily life. The garden is thoughtfully designed to provide a space for outdoor relaxation and recreation, making it an ideal spot for alfresco dining or simply basking in the sunshine. Whether you desire a cosy spot to enjoy your morning coffee or a place to unwind after a busy day, this property's outdoor space is sure to cater to your every need, providing a serene oasis in the heart of Aycliffe Village. Don't miss the opportunity to make this captivating property yours and enjoy the tranquillity and beauty it has to offer.

Council Tax band: A

Tenure: Freehold

- Three bedrooms Terraced Located in Aycliffe Village
- Spacious Lounge, Separate Dining Room
- Three Bedroom & Family Bathroom
- Low Maintenance Rear Garden
- Energy Performance Certificate: C



Entrance Vestibule

Hallway

Lounge

15'1 x 11'10 (4.60 x 3.61m)

Dining Room

9'11 x 9' (3.02 x 2.74m)

Kitchen

13'1 x 5'7 (3.99 x 1.70m)

Bedroom 1

11'7 x 6'7 (3.53 x 2.00m)

Bedroom 2

11'6 x 9'6 (3.50 x 2.90m)

Bedroom 3

8'3 x 6'7 (2.51 x 2.01m)

Bathroom

6'9 x 5'7 (2.06 x 1.70m)



FRONT GARDEN







Ground Floor

Approx. 40.1 sq. metres (432.0 sq. feet)

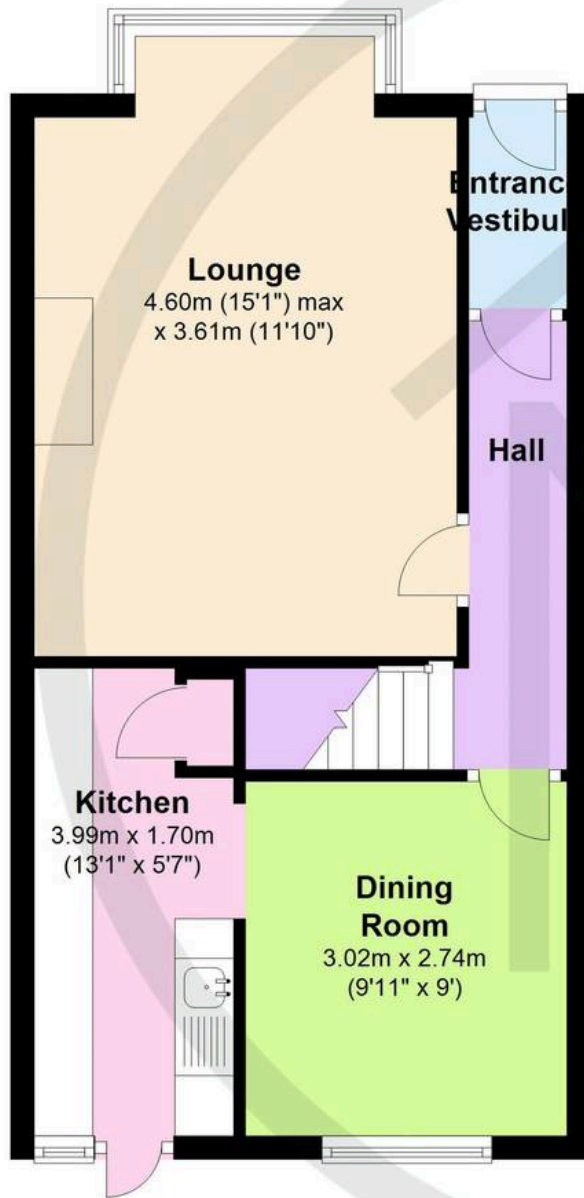

First Floor

Approx. 38.8 sq. metres (417.6 sq. feet)

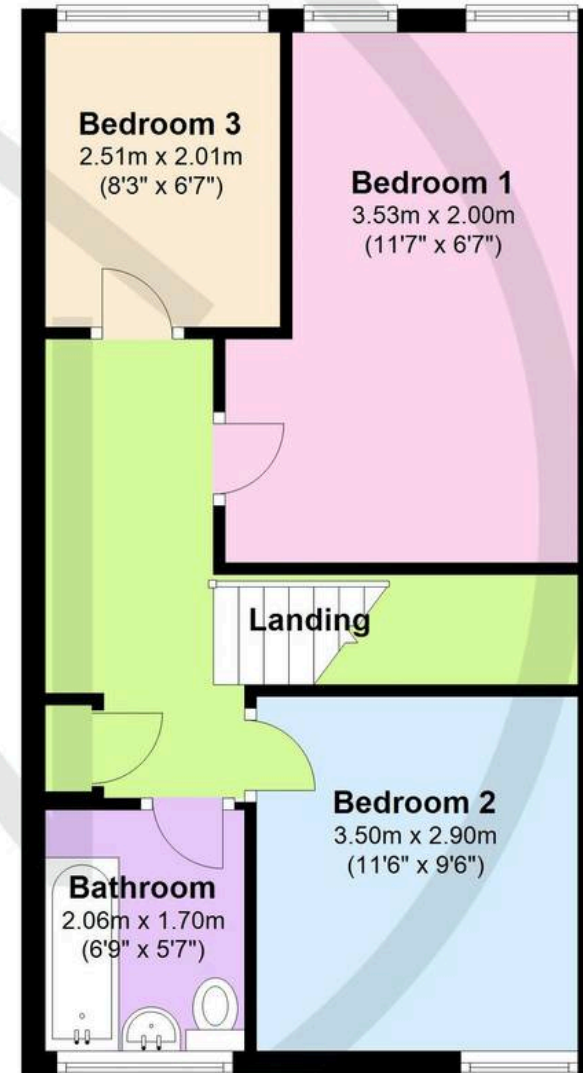

Total area: approx. 78.9 sq. metres (849.6 sq. feet)

floor plan for illustration purpose only.
Plan produced using PlanUp.



Northgate - County Durham

Northgate Estate Agents, Suite 3 - DL5 4DH

01325 728333 • info@northgates.net • www.northgates.co.uk/



These particulars do not constitute, nor constitute part of, an offer or contract. No warranties are provided. Verify details through inspection. Northgate estate agents, nor any person in their employment has any authority to make or give any representation or warranty whatever in the relation to this property. All measurements are approximate.